

Screwdriver Bit Quotation Worksheet













For quotation only. Not an order.





NAME _____ TITLE _____

COMPANY _____

ADDRESS _____ CITY _____ STATE _____ ZIP _____

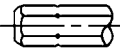
E-MAIL _____ PHONE _____ FAX _____

Style	Point Size	Style	Point Size	Style	Point Size	Style	Point Size
<input type="checkbox"/> Phillips		<input type="checkbox"/> Torx®		<input type="checkbox"/> Frearson/Reed Prince		<input type="checkbox"/> Torx-Set®	
<input type="checkbox"/> Phillips ACR®		<input type="checkbox"/> Torx Plus®		<input type="checkbox"/> Socket Head		<input type="checkbox"/> Triple Square	
<input type="checkbox"/> Slotted		<input type="checkbox"/> Pozidriv®		<input type="checkbox"/> Square		<input type="checkbox"/> Tri-Wing	
						<input type="checkbox"/> Other _____	

Drive Type	Size
<input type="checkbox"/> Hex Insert	 _____
<input type="checkbox"/> Hex Power	 _____
<input type="checkbox"/> Threaded	 _____
<input type="checkbox"/> Female Square	 _____
<input type="checkbox"/> Other _____	_____

Nylon Covers Requirements:

Components To Be Covered

- Bit only
- Bit and Bit Holder

Cover Features

- Flush with tip of bit
- Exposed tip of bit
- Retractable
- Embedded magnets
- Press fit
- Free-spinning (able to spin independently of part being covered)
- O.D. limitations (must specify) _____
- Other considerations (must specify) _____

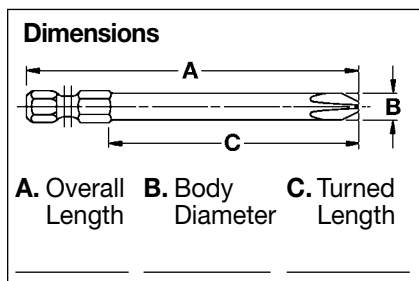

Bit Holder Styles For Hex Insert Bits

- Magnetic
- O-Ring Retention
- Standard (Retaining Groove)
- Quick Release
- Other _____

Bit Holder Drive Types

- | Drive Type | Size |
|--|-------|
| <input type="checkbox"/> Hex Drive | _____ |
| <input type="checkbox"/> Female Square | _____ |
| <input type="checkbox"/> Other _____ | |

Quantity _____

Applied or Driving Torque _____

Additional Specifications _____

Sockets Quotation Worksheet

For quotation only. Not an order.

NAME _____ TITLE _____

COMPANY _____

ADDRESS _____ CITY _____ STATE _____ ZIP _____

E-MAIL _____ PHONE _____ FAX _____

Socket Type

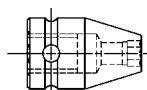

Type A (tapered)

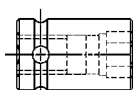

Type B (straight)

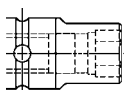

Type C (shouldered)

Broach Opening



Hex



Double Square

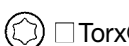

Torx®



Double Hex



Fast Lead

Other



Square



Surface Drive

Magnetic

Magnetic Bolt Clearance (MB)

Magnetic Bolt Clearance, with retaining ring (RMB)

Strip Magnet (SM)

Fixed Magnet (M)

Non-magnetic

Drive Configuration

DIN Standard

No DIN groove

Cross Hole (one wall only)

Extensions

Hex Drive

Female Square

Other _____

Size

Extension Length

No extension required

Nylon Covers Requirements:

Components To Be Covered

Socket only

Socket and Extension

Cover Features

Exposed tip of socket hex

Recessed tip of socket hex

Flush tip of socket hex

Press fit

Free-spinning (able to spin independently of part being covered)

O.D. limitations (must specify) _____

Other considerations (must specify) _____

Quantity

Applied or

Driving Torque

Additional Specifications

Dimensions

A. Square drive _____

B. Drive end diameter _____

C. Overall length _____

D. Taper or shoulder length _____

E. Bolt clearance depth _____

F. Broach depth _____

G. Nose end diameter _____

H. Broach opening _____

I. Torx® size _____

Universal Wrench Quotation Worksheet

For quotation only. Not an order.

NAME _____ TITLE _____

COMPANY _____

ADDRESS _____ CITY _____ STATE _____ ZIP _____

E-MAIL _____ PHONE _____ FAX _____

Dimensions

Female square drive, standard type

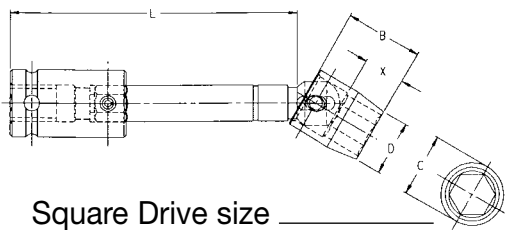

Female square drive, tension type

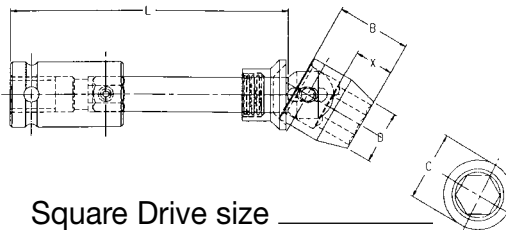

Male hex drive, standard type

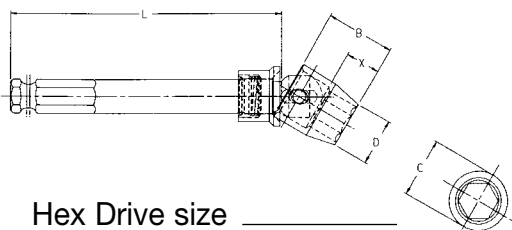

Male hex drive, tension type

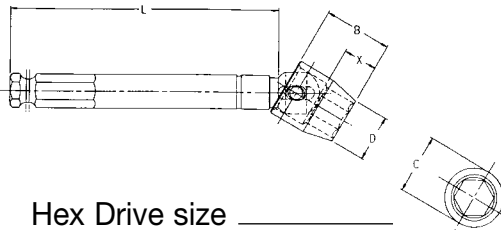

Female square drive, (short)

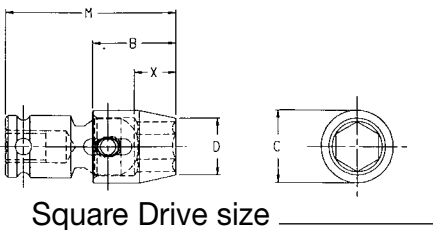

B. Socket length _____ **C.** Socket diameter* _____

D. Socket nose dia. _____ **G.** Depth of Clearance _____

L. Shank length _____ **M.** Overall length _____

*Standard diameters are 5/8", 3/4", 7/8", 1", 1 1/4", 1 1/2", 1 3/4", 2"

Broach Opening Style & Size

Hex _____

Double Hex _____

Quantity _____

Male square

Pin lock _____
 Ball lock _____
 Hole _____

Applied or Driving Torque _____

Additional Specifications _____